

OVISLINK

Call Center Headset OVHS072-V25

(Compatible with AT&T and Panasonic Home Office Phones)

User Manual

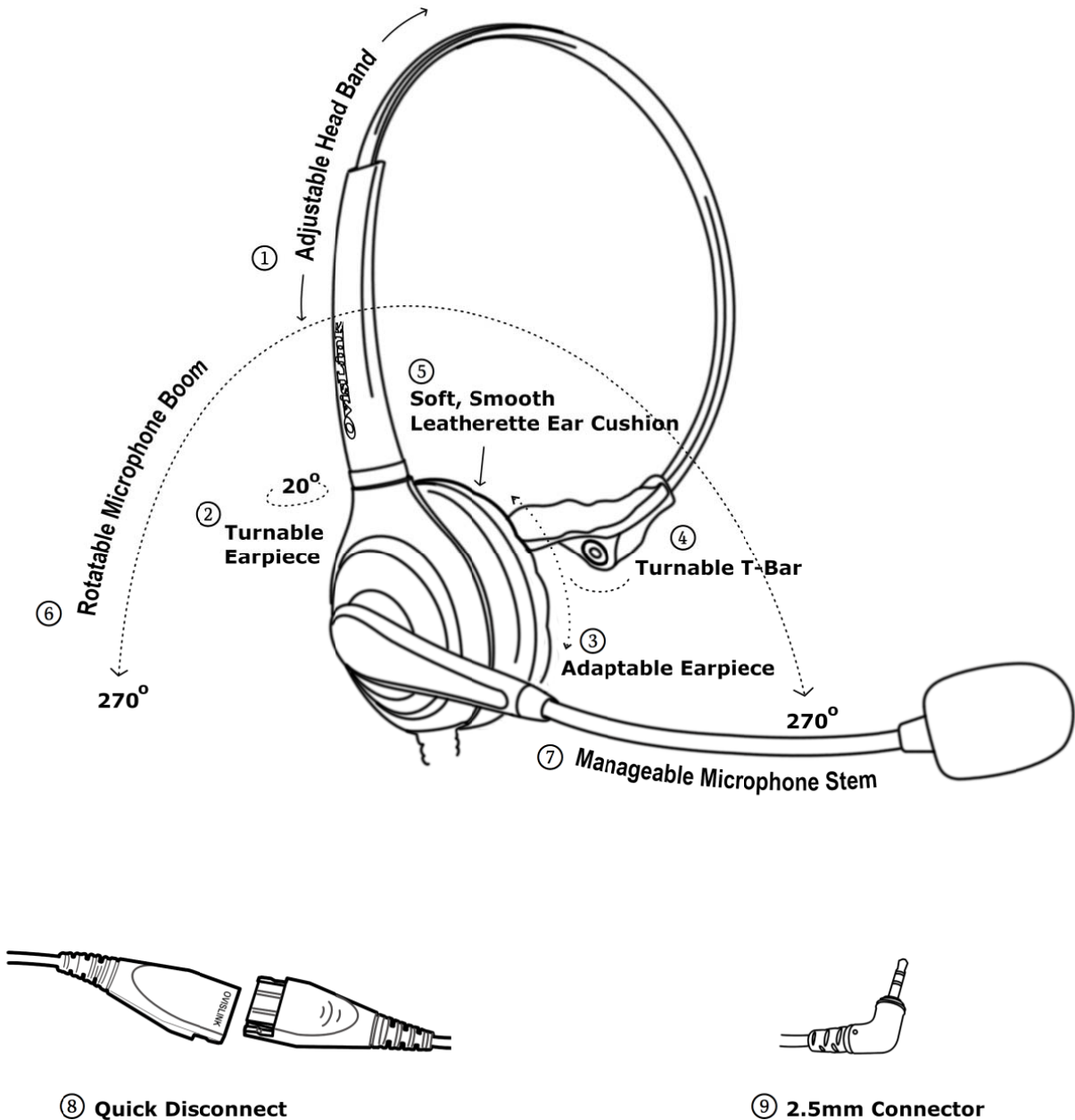

Package Contents:

1 Unit of OvisLink Single Ear Headset

1 Unit of OvisLink 2.5mm Quick Disconnect Cord with Volume control and Mute button

Features:

- 1) Adjustable Headband - Headband adjusts to the desired length and stays in position.
- 2) Turnable Earpiece - Earpiece can be turned within 20° to fit with user's ear.
- 3) Adaptable Earpiece – Earpiece adapts to the user's ear moving up and down to align with user's head and ear structure for comfort.
- 4) Turnable T-Bar - The T-Bar on the side with no earpiece can be turned to fit with user's head and give stability to the headset.
- 5) Soft, Smooth Leatherette Ear cushion - Very smooth leatherette ear cushion lets user feel comfortable for long periods of time.
- 6) Rotatable Microphone Boom - Microphone boom can be rotated 270°, user may place the headset speaker on the left or right ear anytime as he/she wants.
- 7) Manageable Microphone stem - Microphone stem is manageable. User may adjust the microphone to the desired spot and it will stay in place.
- 8) Quick Disconnect - The headset cord can be disconnected at the middle, just simply unplug it. Unplugging on and off will not drop the call, you may also mute and unmute the call.
- 9) 2.5mm Connector - One Quick Disconnect cord with 2.5mm connector that connects the headset with AT&T and Panasonic Home Office Phones.
- 10) Clothing Clip – User can clip the headset cord to his/her shirt for stability using the clothing clip.
- 11) Tangle-less headset cord - The headset cord is tangle-less, will not twist even use it for long time.
- 12) Long headset cord - Upper cord + Coiled Quick Disconnect cord is about 5 ft long and can be stretched to 7 ft.

Instruction:

1. Connect the **2.5mm Quick Disconnect Cord** to the phone's 2.5mm headset jack directly.
2. Adjust the length of the headband and turn the earpieces slightly until the headset fits comfortably.
3. Rotate the microphone boom to put the microphone in front of the mouth.
4. To optimize the position of the microphone, adjust the microphone stem in either direction so the microphone is close to the corner of your mouth and the white dot at the microphone should be facing to your mouth.
5. Attach the clothing clip at a comfortable level to keep the headset properly positioned and free from the cord's weight.
6. Press the headset key on the telephone keypad to get dial tone to the headset, answer an incoming call and disconnect call.

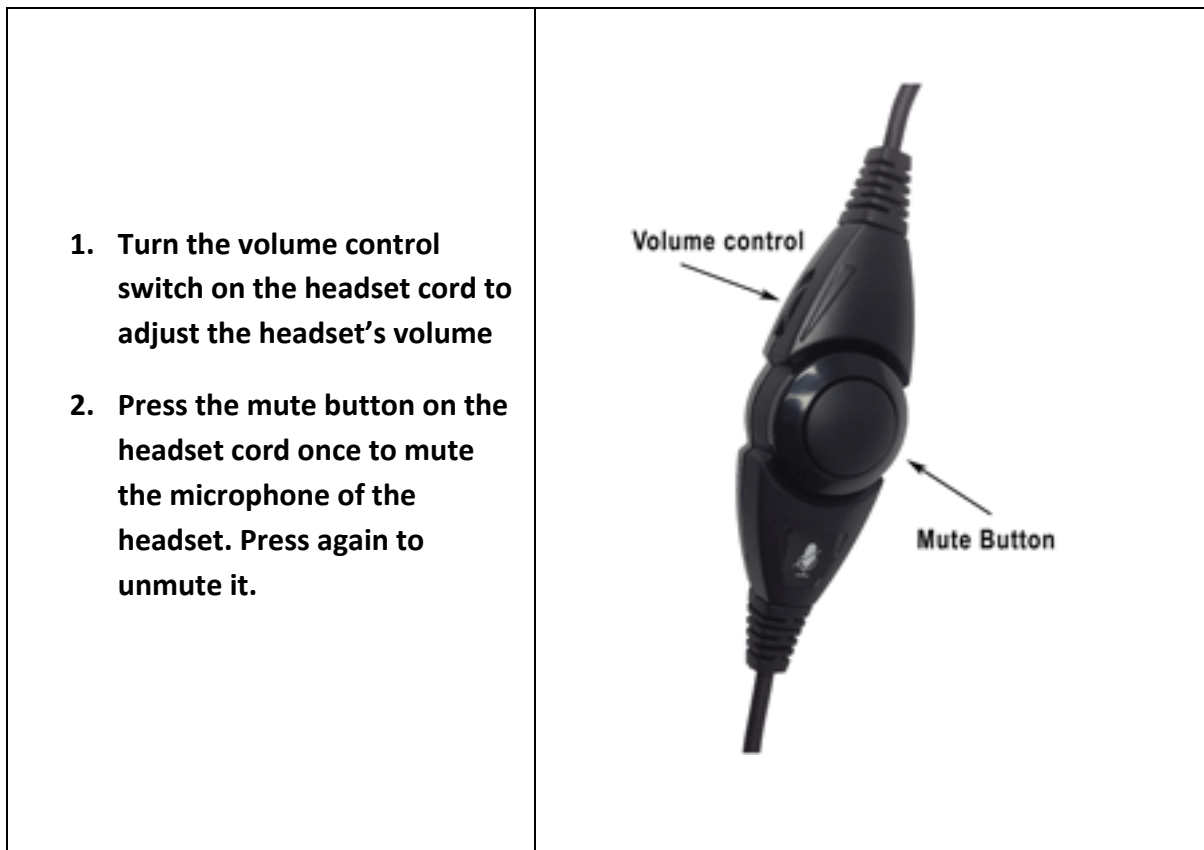

***** If you can't hear dial tone from the headset after pressing the headset key on the phone that means the 2.5mm headset jack has not completely been plugged into the headset port yet. Push harder; you should feel a click and then the headset will work.**

7. For your convenience; if you need to disconnect the headset from the phone, just pull the Quick Disconnect connector at the middle of the headset cord to disconnect. It will not drop the call even if you're in a phone conversation. Plug it back to continue the conversation.

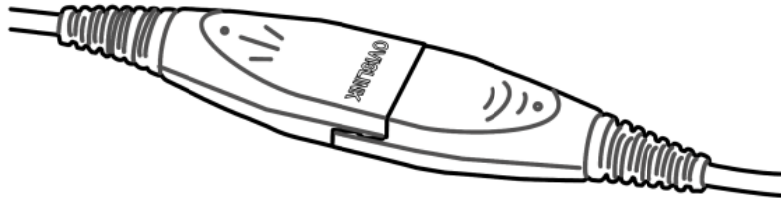

*** OvisLink headset model OVHS072-V25 is specially designed for AT&T and Panasonic Home Office Phones. If you have other telephone brands or any problems, please contact OvisLink at support@ovislink.com